



# Jablite Profile Roof Board

## Profile Roof Insulation

Jablite Profiled Roof insulation is a closed cell expanded polystyrene (EPS) insulation panel suitable for use over cement based profiled roof decks.

- Bespoke profiles are available cut by CNC to suit any existing or new cladding profile
- Boards are supplied profile cut on one or both sides
- Double profile available with the same or different profiles top and base
- Sample profiles provided to site to ensure an accurate fit before full installation
- Risk of condensation is reduced by creating a warm roof
- Assists in spreading loads over existing weak profiled roof decks and eliminates further weathering when used in conjunction with a new waterproof membrane or sheet
- Resistant to the effects of freeze/thaw
- Global Warming Potential <5
- Ozone Depletion Potential = Zero

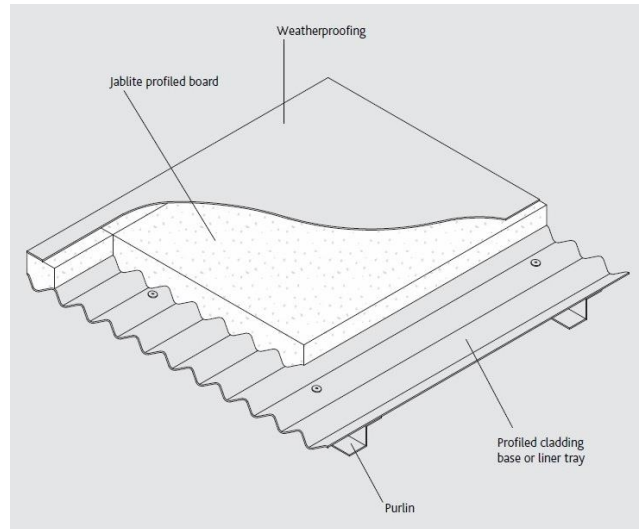

Jablite Profiled Boards are available as un-faced EPS for use with a profiled cladding overlay or fleece backed single ply PVC membranes. Flat topped boards are also available with a laminate to suit EPDM, Bituminous Felt and Liquid Applied membranes.

The panels are lightweight and easy to install. There are no requirements for special PPE when installing or cutting the insulation panels. (full installation details are shown later)

Jablite Profiled Boards are manufactured in accordance with BS EN ISO 13163 under a Quality Assurance System approved to BS EN ISO 9001 and Environmental Management System to ISO 14001.

### Dimensions

<b>Board Sizes</b>	Maximum size - 2400 x 1200mm
<b>Thickness</b>	20mm up to 600mm In 5mm increments (single layer)

### PROPERTIES

Grade	Thermal Conductivity (Lambda) (W/mK)	Design load at 1% nominal compression (kPa)	Design load at 10% nominal compression (kPa)
Profiled Board 70	0.038	20	70
Profiled Board 100	0.036	45	100
Profiled Board 150	0.035	70	150



### APPLICATION – Product Selection

	Profiled Board (Unfaced)	Profiled Board with 3B Felt Facing	Profiled Board with HP Felt Facing	Profiled Board with HP Torch-on Felt Facing
Metal, Cement or GRP Profiled Sheet over insulation	✓			
Single Ply – PVC	✓			
Single Ply – TPO	✓			
Single Ply – EPDM (Rubber)		✓		
Liquid Applied		✓	✓	
Built up Felt		✓	✓	✓

### Compressive Strength

Jablite Profiled Boards are available in grades 70, 100 and 150 dependent on the load they are required to take in use.

Grade 70 – used where the profiled insulation will not be under load, usually where a second profiled sheet is placed over the insulation and mechanically fixed to the existing deck.

Grade 100 – over any roof subject to maintenance traffic only

Grade 150 – recommended as a minimum grade where there may be constant foot traffic

Please note the load bearing capacity of existing roof decks should be checked prior to installation.

### U Values

The U value for a roof with Jablite Profiled Board insulation is calculated in accordance with BS EN ISO 6946 and based on the average thermal resistance of the insulation. The thermal resistance and therefore overall thickness of insulation required will vary greatly dependent on the depth and shape of the contours cut into the insulation boards.

U values will be calculated for each individual project based on the profile design required and advice on thickness to achieve the required U value will be given.

### Weatherproofing

The choice of Jablite Profiled Roof Insulation product is largely dependent on the weatherproofing membrane/sheet to be used on the site.

Jablite Profiled Board is available un-faced and faced with a range of laminates to make a high performance insulation panel suitable for all applications.

The following shows standard weatherproofing currently available and the appropriate Jablite Profiled Board for use with each type.



## APPLICATION – Product Selection

<b>Profiled Cladding</b>	Unfaced
--------------------------	---------

Where a secondary or new profiled sheet is to overlay the Jablite Profiled Board there is no requirement for a facing on the EPS insulation boards.

The new profiled cladding should be mechanically fixed through the insulation to the existing deck below.

<b>Single Ply – PVC (fleece Backed)</b>	Unfaced
-----------------------------------------	---------

Fleece backed Single Ply PVC weathering membranes may be installed directly onto un-faced Jablite Profiled Board.

Most PVC single ply membranes are available with proprietary adhesives as part of the system supplied by the membrane manufacturers. Adhesives used with un-faced Jablite Profiled Board must be solvent free, the typical adhesive type used is polyurethane based spray. Mechanical fixings may also be used and must be suitable for fixing through the profiled deck below the insulation.

<b>Single Ply - TPO</b>	Unfaced
-------------------------	---------

Where a TPO membrane is to be mechanically fixed or fully adhered with a solvent free adhesive our un-faced Flat Roof and High Performance Boards may be used.

Hybrid 25 is recommended where solvent based adhesives are to be used with this type of membrane. There is no requirement to provide a separation layer between the Jablite insulation and the membrane other than protection against solvent attack.

<b>Single Ply – EPDM (rubber)</b>	Faced with Type 3B Felt
-----------------------------------	-------------------------

Profiled Board with a Type 3B Felt membrane is recommended for use below EPDM weatherproofing membranes. Available in all compressive strengths.

<b>Liquid Applied</b>	Faced with Type 3B or HP Felt
-----------------------	-------------------------------

Most liquid applied membranes may be directly applied to Profiled Boards with either a Type 3B felt or SBS modified high performance felt factory bonded to the top surface.

We recommend seeking advice from the liquid applied membrane suppliers regarding the most appropriate laminate.

<b>Built up Felt</b>	Faced with Type 3B, HP or HP Torch Felt
----------------------	-----------------------------------------

Pour and roll applied 3B and HP felts – Where the felt weatherproofing is to be applied by bedding in hot bitumen it is recommended that the Profiled Board with an HP membrane bonded to the top surface are used. Hot bitumen must always be applied by mop to reduce the temperature.

Torch-on felts may be applied as normal to the surface of Profiled Boards which would be supplied with a single layer of HP Torch felt factory bonded to the surface.



## APPLICATION

### Installation

Jablite Profile Boards are positioned on top of existing profiled cladding sheet and covered by either a weatherproofing membrane or new profiled cladding sheet.

Overlaying an existing profiled deck reduces the risk of condensation on the underside of the deck and prevents further deterioration of the deck through the process of weathering.

### Deck

Existing decks must be brushed clean free of loose material and any organic growth or vegetation must be removed prior to installing the insulating Profiled Boards.

Any defects in the existing deck must be made good.

### Vapour Control Layer

A suitable vapour control layer (VCL) should be installed over the deck when necessary to reduce condensation.

The most effective VCL over profiled decking is liquid applied.

### Profile Insulation Boards

Existing profile roof decks often change shape over time and the profile of the roof may differ from the original design drawing.

In order to ensure an effective fit for the insulation, sample boards will be cut to the manufacturers original profile drawing and supplied to site for assessment of fit.

Once any necessary adjustments have been made to the profile shape the panels are supplied to site and fitted according to the requirements of the weathering to be placed over the boards.

Where the weatherproofing is to be mechanically fixed the Jablite Profile Boards may be temporarily adhered to the deck with a solvent free polyurethane adhesive.

### Weatherproofing

Where a proprietary weatherproofing system is to be installed the recommendations and instructions of the system supplier should be followed.

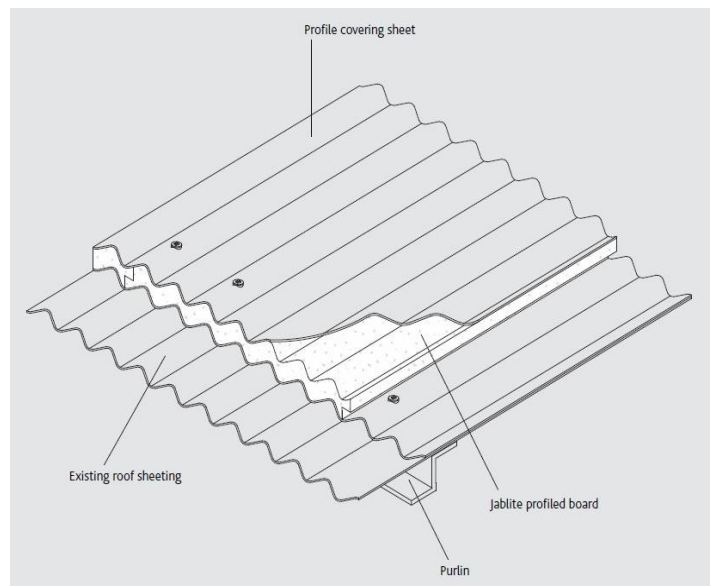
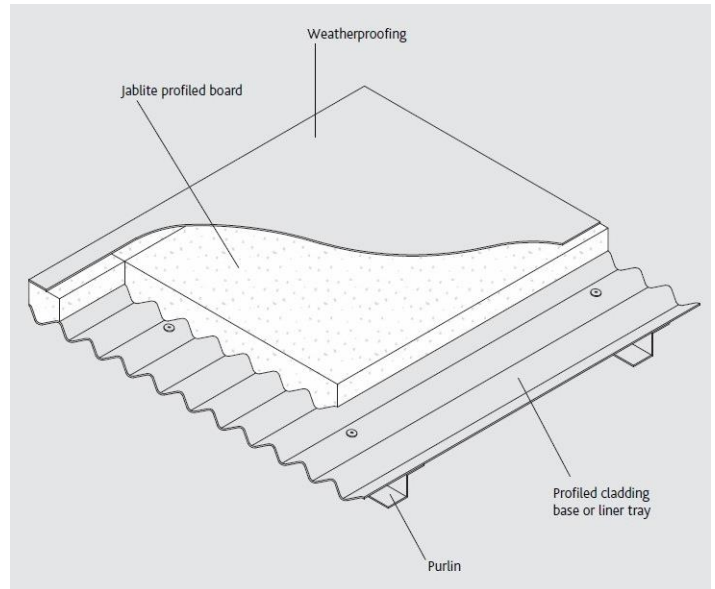



**Accreditation :**

<b>CE marking</b>	<p>Jablite have taken the responsibility of CE marking the product in accordance with harmonised European Standard BS EN 13163 : 2012.</p> <p>Declaration of Performance is available on Request.</p>
<b>Quality</b>	<p>All Jablite products are manufactured in production facilities which are certified to ISO 9001 Quality Management</p>
<b>Environmental Responsibility</b>	<p>All Jablite manufacturing facilities are ISO 14001 certified.</p> <p>We operate an Environmental Management System which includes our supply chain (see BREEAM section for more information)</p>
<b>Compliance</b>	<p>Jablite Flat Roof Insulation conforms to the required properties as defined in BS EN 13163:2012 – Thermal insulation products for buildings – Factory made expanded polystyrene (EPS) products – Specification. This standard supersedes the previous manufacturing standard BS 3837 Part 1</p>
<b>Fire</b>	<p>The fire performance will be dependent on the roof deck and weatherproof finish.</p> <p>Jablite Profiled Board should only be used over cement based cladding or other non-combustible profiled decks.</p>





**Environment and Sustainability :**

**B R E E A M Non-Domestic Refurbishment 2015**

Mat 01 : Life Cycle Impacts	<p><b>Credits available:</b>  <b>2 – Industrial Buildings</b>  <b>5 – All other Building Types</b></p> <p>Points may be gained where at least 5 products specified at Design Stage are covered by a verified Environmental Product Declaration (EPD)</p> <p>EPD's produced by EUMEPS on behalf of a group of European EPS Manufacturers including Jablite are available on the website below within the Construction section under Documents  <a href="http://www.eumeps.org/">http://www.eumeps.org/</a></p>
Mat 03 : Responsible Sourcing of Construction Products	<p><b>Credits available : 4</b></p> <p>BREEAM Summary Score – 2 for EMS (Certified) Key process and Supply Chain for EPS Insulation</p> <p>Jablite insulation products are manufactured using low energy processes in factories which are ISO 14001 and ISO 9001 certified. Jablite only purchases raw material from suppliers who are ISO 14001 certified. The ISO certificates are in the Technical Resource Centre on the Jablite website  <a href="http://www.Jablite.co.uk">www.Jablite.co.uk</a></p> <p><b>Key Process (Insulation Manufacture)</b>          ISO 14001: Certificate Number EMS 559414</p> <p><b>Key Supply Chain Process (Main Polymer Production)</b>          ISO 14001: Certificate Number 80130-2010-AE-FRA-COFRAC Rev. 4</p>
Mat 04 : Insulation	<p>Insulation products are now covered within Mat : 01 and Mat : 03 (see above) included within the construction elements into which they are installed</p>

	PROFILED BOARD 70	PROFILED BOARD 100	PROFILED BOARD 150
BRE Green Guide Rating	<b>A+</b> Element number 815320022	<b>A+</b> Element number 1315320023	<b>A+</b> Element number 1315320024
Climate Change	Ozone Depletion Potential (ODP) = <b>zero</b> Global Warming Potential (GWP) < <b>5</b>		
100%	Jablite Flat Roof Boards are 100% recyclable		

